

RQA series

Thermal Fuse Built-in Resistors

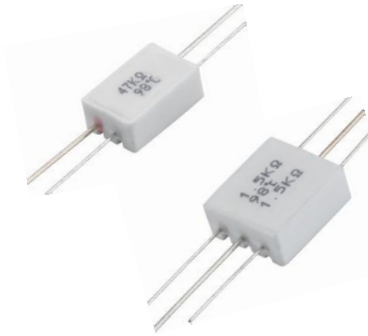

- Temperature Fuse with Heater
- This Product Has an Insulated Heater Element and Thermal Fuse, So the Fuse Can Be Forcibly Melted by External Heating or Abnormal Heat Caused by Excessive Power in the Heater Element, Making it Ideal as a Sensor to Improve the Safety of Any Device Regardless of Field.

■ RATINGS

Rated Power	Resistance Range	Temperature fuse Rated Current	No. of elements	Nominal operating temp	Limiting Voltage
2W / 1 element power unrelated to fuse melting	34Ω ~20KΩ	10A	1 element 2 elements	98℃ ~128℃	AC250V

■ FRAME

Axial Type 3p

Axial Type 2p

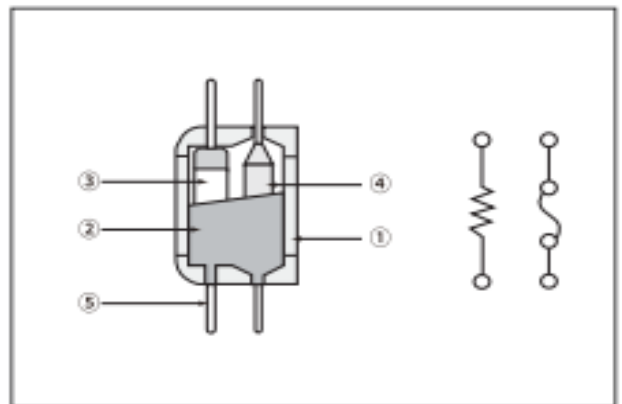
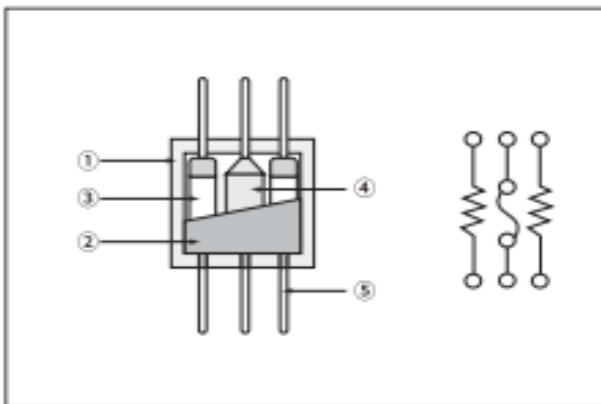

① Ceramic Case

② Ceramic filler

③ Resistor

④ Temperature Fuse

⑤ Lead Wire

■ DIMENSIONS

RQA-2P

A	B	C	D	E	F	G
5±0.5	20	20±0.5	13±0.5	8±0.5	0.7±0.04	0.58±0.04

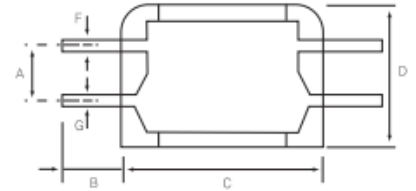

Power Rating(25℃)		2W
Nominal Resistance Value		330Ω ~ 56KΩ
Resistance Tolerance		±5%
Thermal Fuse	Model	SW-104T
	Tf	98℃
	Rated Voltage	AC250V
	Rated Current	10A



RQA-3P

A	B	C	D	E	F	G
4.6±0.5	20	20±0.5	18±0.5	8±0.5	0.7±0.04	1.0±0.04

Power Rating(25℃)		2W
Nominal Resistance Value		330Ω ~ 56KΩ
Resistance Tolerance		±5%
Thermal Fuse	Model	SW-104T
	Tf	98℃
	Rated Voltage	AC250V
	Rated Current	10A

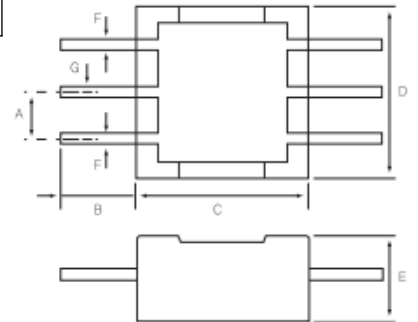

■ HOW TO ORDER

RQA	FUSE	2W	1.5KΩ	J	2P	Tf
TYPE	THERMAL	POWER RATING	NOMINAL RESISTANCE	RESISTANCE TOLERANCE	3P	RATED FUNCTIONING TEMP. Tf

www.resistors.co.kr

Tel +82-7648216